

## Resilient Seated Solid Wedge Gate Valve With Bevel Gear Operator - Series 6800

AWWA C509 & C515 ▪ NRS Type ▪ FL x FL ▪ Sizes 18" - 24"

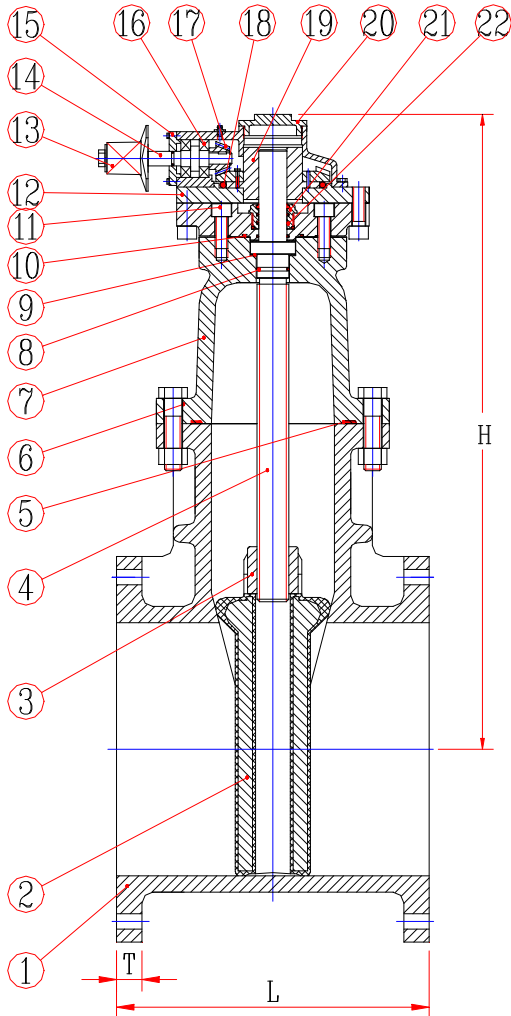

**Note: Spur gear configuration, available.  
Gears can be rotated in 90° increments.**

No.	Part Name	Materials
1	Body	Ductile Iron ASTM A536 65-45-12
2	Wedge	Ductile Iron EPDM Encapsulated
3	Stem Nut	Bronze ASTM B62 Low Zinc
4	Stem	Stainless Steel
5	O-Ring Gasket	EPDM
6	Bolts	Stainless Steel AISI 304
7	Bonnet	Ductile Iron ASTM A536 65-45-12
8	O-Ring	EPDM
9	Washer	Copper ASTM B16
10	O-Ring	EPDM
11	Bolts	Stainless Steel AISI 304
12	Bottom Cap	Cast Iron ASTM A126 Class B
13	2" Operating Nut	Ductile Iron ASTM A536 65-45-12
14	Shaft	Carbon Steel AISI 1045
15	Press Cover	Cast Iron ASTM A126 Class B
16	Housing	Cast Iron ASTM A126 Class B
17	Bevel Gear	Carbon Steel AISI 1045
18	Ball	Carbon Steel AISI 1045
19	Driving Sleeve	Ductile Iron ASTM A536 65-45-12
20	Top Cover	Cast Iron ASTM A126 Class B
21	Sealing Sleeve	Brass ASTM B16
22	O-Ring	EPDM

### Standard Features:

- Design and Materials Exceed AWWA C509, C515 & C550.
- Flanges Conform to ANSI B16.1, Class 150.
- Ductile Iron: Body, Bonnet, Wedge, and Gland.
- Fusion Bonded Epoxy Coatings ANSINSF61  
12 Mils In and Out per AWWA C550.\*
- Stainless Steel Nuts, Bolts, and Washers.
- Stainless Steel Stem.
- Ductile Iron, EPDM Encapsulated Wedge.
- EPDM Gaskets and O-Rings.
- 250 PSI Working Pressure.
- Working Temperature: EPDM 33°F to 248°F.
- 2" AWWA Ductile Iron Nut, Ductile Iron Handwheel  
or Automatic Actuators Available.

### Dimensions:

Size	Model	L	H	OD	T	Approx. Weight
18"	6818	17"	44"	25"	1½"	1,320#
20"	6820	18"	52"	27½"	1¾"	1,920#
24"	6824	20"	58"	32"	1⅞"	2,790#